

Property Data Sheet

2101-2113 Eagle Drive
Middleton, WI 53562



This fully leased, 30,492 sf multi-tenant building features a pre-engineered metal building construction, decorative brick features, varying office build-outs, 4 loading docks, 3 drive-in doors and frontage on Highway 14.



Property Availability/Details

Building Size:	30,492 sf
Site Size:	2.12 acres
Tenancy:	Multi-tenant (6)
Vacancy (6/1/15):	0%
Loading Docks:	4
Drive-In-Doors:	3
Ceiling Heights:	20'+
Office Space:	Yes
Sprinkler System:	Yes
Year Built:	1993



Contact Info: Paul Molinaro
Direct: (608) 661-8803
Cell: (608) 628-5427
paulm@buildtosuit.com

www.buildtosuit.com

2101-2113 Eagle Drive Submarket Aerial



Property Data Sheet

2101-2113 Eagle Drive

Middleton, WI 53562



Floor Plan

Eagle Drive

Highway 14/University Ave

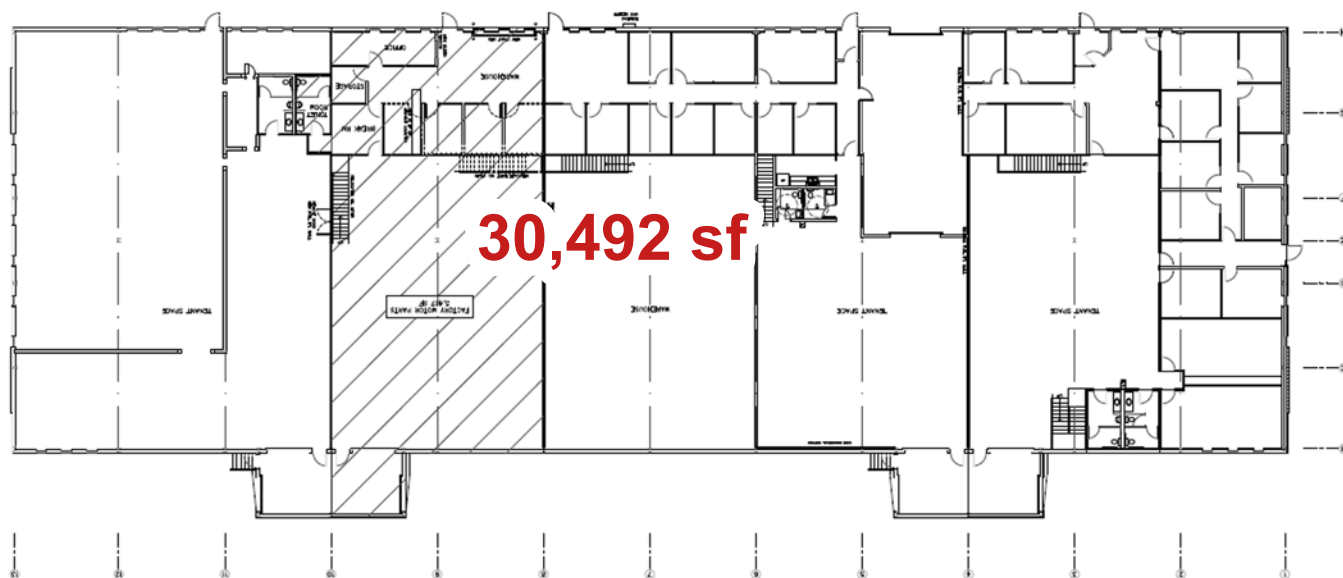

Contact Info:

Paul Molinaro
Direct: (608) 661-8803
Cell: (608) 628-5427
paulm@buildtosuit.com

www.buildtosuit.com

Property Data Sheet

2101-2113 Eagle Drive
Middleton, WI 53562



Site Plan

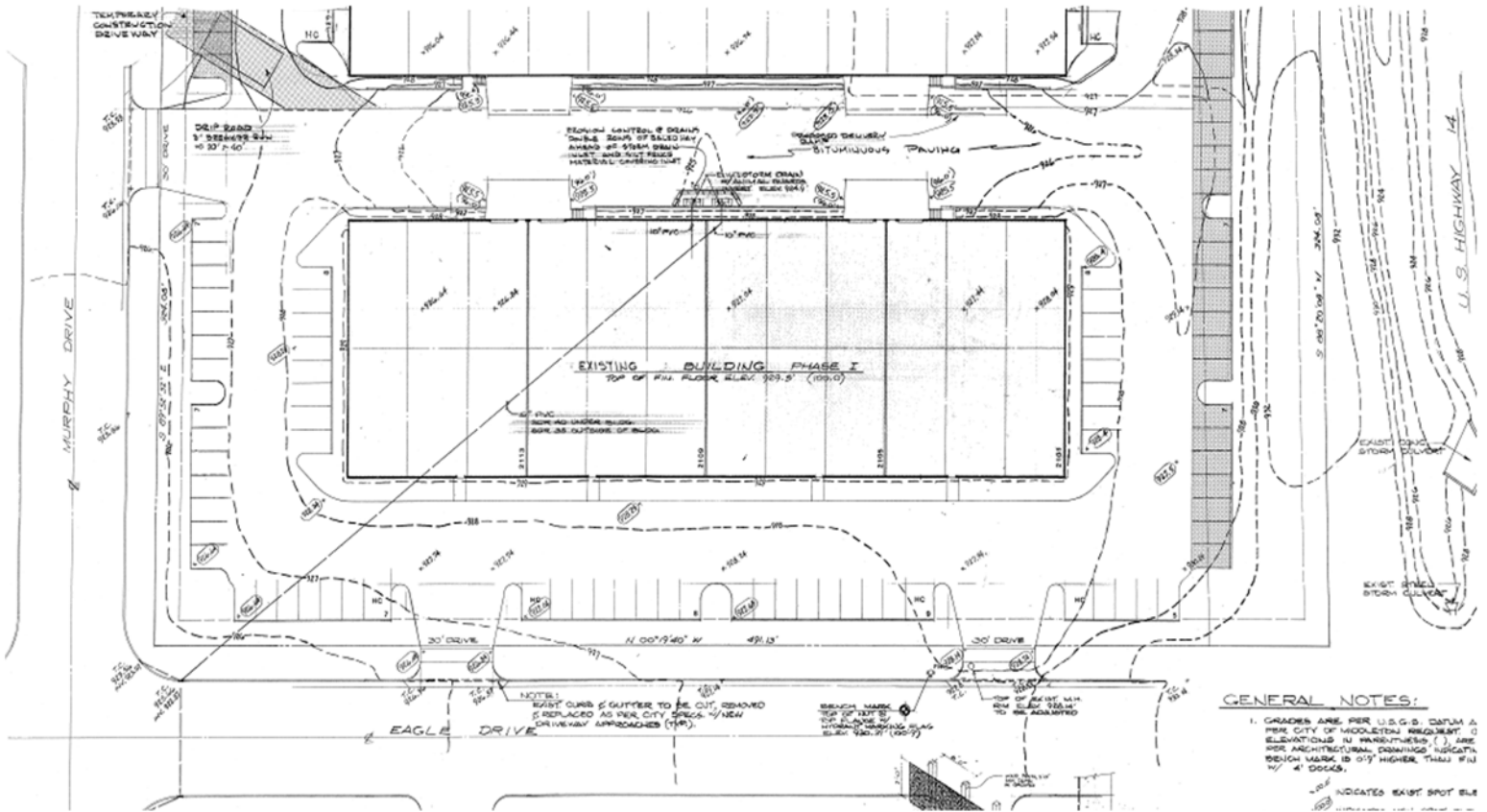

Contact Info: Paul Molinaro
Direct: (608) 661-8803
Cell: (608) 628-5427
paulm@buildtosuit.com

www.buildtosuit.com